

Lote Duplex Lavanda - Zirandaro

\$960,000 MXN

Zirándaro

MAIN FEATURES

- Ref: 10899
- Size Land: 1,609 ft²

Park-front lot located by the Clubhouse within Zirandaro Golf Course in Circuito Lavanda. This 119.85 m² parcel offers feasibility for duplex construction with a total buildable area of 149.60 m², making it an excellent opportunity for investment or a residential project in a privileged golf community.

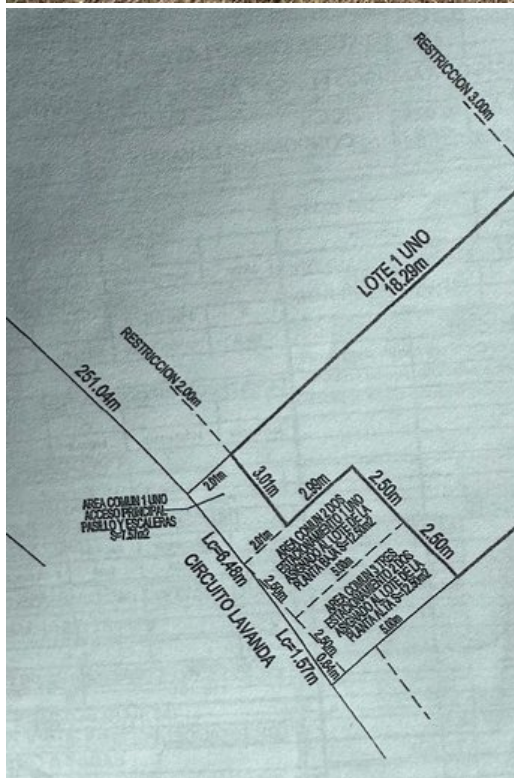

Gloria Farias
 415.153.5059
 gloria@realtysanmiguel.com